

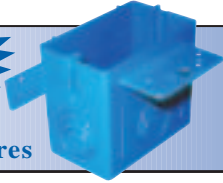

ENT Accessories Features and Benefits

OUTLET AND SWITCH BOXES W/ ECCENTRIC KNOCKOUTS, ENT BRIDGE

Carlon Exclusive



Outlet and Switch Boxes w/ Eccentric Knockouts

Part Numbers: A122, A238, A238DIV
(Patent Pending)



Features	Benefits
• Nonmetallic, Noncorrosive, Nonconductive	<ul style="list-style-type: none"> • Extends product life, eliminates rust & the need for replacement, & provides safe handling/installation. • Lightweight
• Dual Service Capability	<ul style="list-style-type: none"> • The Outlet Box Divider provides a barrier for applications requiring high/low voltage in the same box.
• Eccentric Knockouts	<ul style="list-style-type: none"> • Allows selective ENT openings 1/2", 3/4" and 1"
• Box Capacity	<ul style="list-style-type: none"> • Provides the largest capacity in market – 22 cu. in. Single Gang and 38 cu. in. Double Gang • Able to accommodate any size device.
• Easy Installation	<ul style="list-style-type: none"> • Fast/easy installations - Nail on or screw on. • Wood or Steel Stud installation. • Multiple mounting capabilities. • Saves time and money.
• Made from a highly engineered thermoplastic material	<ul style="list-style-type: none"> • Rugged and Durable.
• Design Styles	<ul style="list-style-type: none"> • Single Gang and Double Gang. The double gang is also a 4 square box.
• Fewer SKUs	<ul style="list-style-type: none"> • One product accepts a number of conduit sizes. • Two Gang doubles as 4 Square Box. • Numerous mounting capabilities. • Dual service.



Single Gang – 22 cu. in.

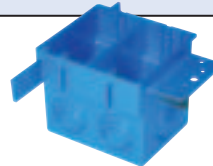

Combination Two Gang/Four Square Box – 38 cu. in.

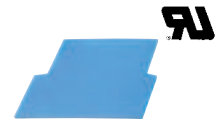

Outlet Box Divider

Carlon Exclusive

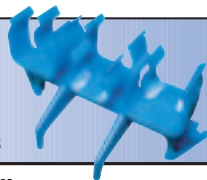

Carlon Exclusive – ENT Bridge

Part Number: A239DEF
(Patent Pending)

Features	Benefits
• Nonmetallic, Noncorrosive, Nonconductive	<ul style="list-style-type: none"> • Extends product life, eliminates rust and the need for replacement, and provides safe handling/installation.
• Flexible	<ul style="list-style-type: none"> • Accommodates ENT and/or rigid conduit sizes 1/2", 3/4" and 1"
• Minimizes Dips	<ul style="list-style-type: none"> • Makes pulling wire/cable fast and easy by maintaining straight runs for ENT. • Saves time and money.
• Anti-Slip Design	<ul style="list-style-type: none"> • Prevents ENT from pulling/slipping out during cable pulls.
• Snap-In Design	<ul style="list-style-type: none"> • Fast/easy installations - Nail on or screw on. • Lay-in snap design. • Saves time and money.
• Made from a highly engineered thermoplastic material	<ul style="list-style-type: none"> • Rugged and Durable. • Will not crush/collapse under the tremendous weight of concrete installations. • Designed to retain conduit; however, less resistant than connectors & boxes, so bridge acts as a strain relief when conduit is stepped on.

CARLON ENT SOLUTIONS: READY TO USE OUT OF THE BOX.

25701 Science Park Drive • Cleveland, Ohio 44122 • (216) 464-3400 • Fax: (216) 766-6444
Gross Automation (877) 268-3700 • www.carlonsales.com • sales@grossautomation.com